



**LOAF** \_bench

design : Keiji Takeuchi  
2019 / 2025

**by interiors Tokyo**  
4-16-15 Minami Aoyama,  
Minato-ku, Tokyo 107-0062

mail : [byinteriors@interiors-inc.jp](mailto:byinteriors@interiors-inc.jp)  
Web : [www.by-interiors.net](http://www.by-interiors.net)

## LOAF \_ bench

upholstered version : wooden frame , polyurethane foam ( recommended fabric SELAM )

rattan version : wooden frame , rattan

stool base : caster

bench base : fixed glide

recommended fabric SELAM

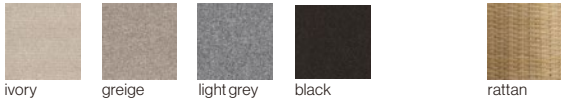

ivory

greige

light grey

black

rattan



stool  
**IN-LOAF-1P**



rattan stool  
**IN-LOAF-1PRAT**



W400xD350xH450  
W15.75"xD13.78"xH17.72"  
caster  
zipper: upholstered version only

H450  
**IN-LOAF-2PN45**

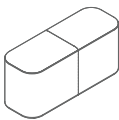

H450 rattan  
**IN-LOAF-2PN45RAT**

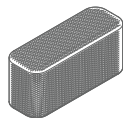

W970xD350xH450  
W38.19"xD13.78"xH17.72"  
fixed glide



H450  
**IN-LOAF-3PN45**

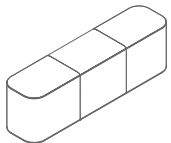

H450 rattan  
**IN-LOAF-3PN45RAT**

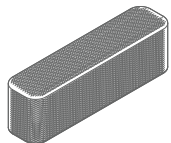

W1450xD350xH450  
W57.09"xD13.78"xH17.72"  
fixed glide

H600  
**IN-LOAF-2PN60**

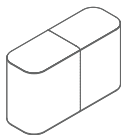

W970xD350xH550  
W38.19"xD13.78"xH21.65"  
fixed glide

H600  
**IN-LOAF-3PN60**

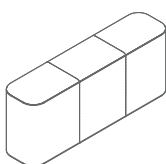

W1450xD350xH550  
W57.09"xD13.78"xH21.65"  
fixed glide

